



INSTALLATION INSTRUCTIONS ASCENT REAR BUMPER

Part Number: 96255

Application: Ford F-150 2015+

GENERAL SAFETY PRECAUTIONS

Your safety, and the safety of others, is very important. To help you make informed decisions about safety, we have provided installation and operating instructions and other information on labels and in this guide. This information alerts you to potential hazards that could hurt you or others. It is not possible to warn you about all potential hazards associated with this product, you must use your own good judgment.

CARELESS INSTALLATION AND OPERATION CAN RESULT IN SERIOUS INJURY OR EQUIPMENT DAMAGE. READ AND UNDERSTAND ALL SAFETY PRECAUTIONS AND OPERATING INSTRUCTIONS BEFORE INSTALLING AND OPERATING THIS PRODUCT.

This guide identifies potential hazards and has important safety messages that help you and others avoid personal injury or death. **WARNING** and **CAUTION** are signal words that identify the level of hazard. These signal words mean:

▲WARNING signals a hazard that could cause serious injury or death, if you do not follow recommendations. **▲CAUTION** signals a hazard that may cause minor to moderate injury, if you do not follow recommendations.

This guide uses **NOTICE** to call attention to important mechanical information, and **Note:** to emphasize general information worthy of special attention.

▲ WARNING

IMPACT AND MOVING PARTS ENTANGLEMENT HAZARD

Failure to observe these instructions could lead to severe injury or death

- **Always** take time to fully read the Instructions and/or Operations Guide, and/or Basic Guide to Winching Techniques, in order to understand your winch and its operations.
- **Always** use extreme caution when drilling on any vehicle. Make sure that all fuel lines, brake lines, electrical wires, and other objects are not punctured or damaged when/if drilling on the vehicle. Thoroughly inspect the area to be drilled (on both sides of material) prior to drilling, and relocate any objects that may be damaged. Failure to inspect the area to be drilled may result in vehicle damage, electrical shock, fire or personal injury.
- **Always** wear safety glasses when installing this kit. A drilling operation will cause flying metal chips. Flying chips can cause eye injury.
- **Always** use extreme caution when cutting and trimming during fitting.
- **Always** remove jewelry and wear eye protection.
- **Never** lean over battery while making connections.
- **Never** route electrical cables:
 - o Across any sharp edges.
 - o Through or near moving parts.
 - o Near parts that become hot.
- **Always** insulate and protect all exposed wiring and electrical terminals.
- **Always** install terminal boots as directed in installation instructions.
- **Always** use appropriate and adequate care in lifting components into place.
- **Always** insure components will remain secure during installation and operation.
- **Always** tighten all nuts and bolts securely, per the installation instructions.
- **Always** perform regular inspections and maintenance on the plow mechanism, fasteners, cable and related hardware.
- **Always** replace all worn or damaged parts before operating.
- **Never** operate this WARN product with damaged or missing parts.

Read installation and operating instructions thoroughly.

WARN INDUSTRIES, INC. 12900 S.E. Capps Road,
Clackamas, OR USA 97015-8903, 1-503-722-1200, FAX: 1-503-722-3000
Customer Service: 1-800-543-9276
Dealer Locator Service: 1-800-910-1122
International Fax: 1-503-722-3005

⚠ CAUTION

MOVING PARTS ENTANGLEMENT HAZARD

Failure to observe these instructions could lead to minor or moderate injury

- **Always** take time to fully read and understand the installation and Operations Guide included with this product.
- **Never** operate this product if you are under 16 years of age.
- **Never** operate this product when under the influence of drugs, alcohol or medications.

Read installation and operating instructions thoroughly.

NOTICE

EQUIPMENT DAMAGE

- **Always** refer to the Installation and Specification Guide, supplied in the winch kit, for all wiring schematics and specific details on how to wire this WARN product to your vehicle.

Read installation and operating instructions thoroughly.

BEFORE YOU BEGIN

NOTICE



This product may interfere with driver assist systems such as adaptive cruise control and parking assist systems that have sensors or cameras installed in the bumpers or front grill area. If your vehicle is equipped with any of these systems or features, consult your vehicle owner's manual before installing this product. These systems may need to be disabled as a result of installing this product.

TABLE OF CONTENTS

Tools Required.....	page 2
Torque Specifications.....	page 2
Parts List.....	page 3
Installation.....	page 4-8
Maintenance/Care.....	page 8

TOOLS REQUIRED

- Standard wrenches
- Standard sockets

TORQUE SPECIFICATIONS

Please use the recommended torque specifications when assembling this product unless otherwise specified in the instructions.

FASTENER SIZE	FASTENER TORQUE		FASTENER SIZE	FASTENER TORQUE	
	lb-ft	(N.m)		lb-ft	(N.m)
1/4"	8	(11)	M4	(2)	3
5/16"	17	(23)	M5	(4.5)	6
3/8"	30	(40)	M6	(7.5)	10
7/16"	48	(66)	M8	(18)	25
1/2"	74	(100)	M10	(37)	50
9/16"	106	(144)			
5/8"	148	(200)			
3/4"	269	(364)			

PARTS LIST

ITEM	PART NO.	DESCRIPTION	QTY	ITEM	PN	DESCRIPTION	QTY
A1	95575	Rear Bumper	1	B1	1824	7/16 - 14 X 1 -1/4 Hex Head Capscrew	8
A2	96283	LH Outer Bracket	1	B2	22454	7/16 -14 x 1.25 Carriage Bolt	8
A3	96273	LH Inner Bracket	1	B3	710123	7/16 -14 Locking Nut	16
A4	96274	RH Inner Bracket	1	B4	9213	1/2 Washer	24
A5	96272	RH Outer Bracket	1	B5	96546	Locking Plug	4
A6	96285	Light Bezels	2	B6	13231	1/2-13x1 1/2 Hex Capscrew	12
				B7	91541	10-24 Socket Head	16
				B8	73665	Tinnerman Spread Nut	16

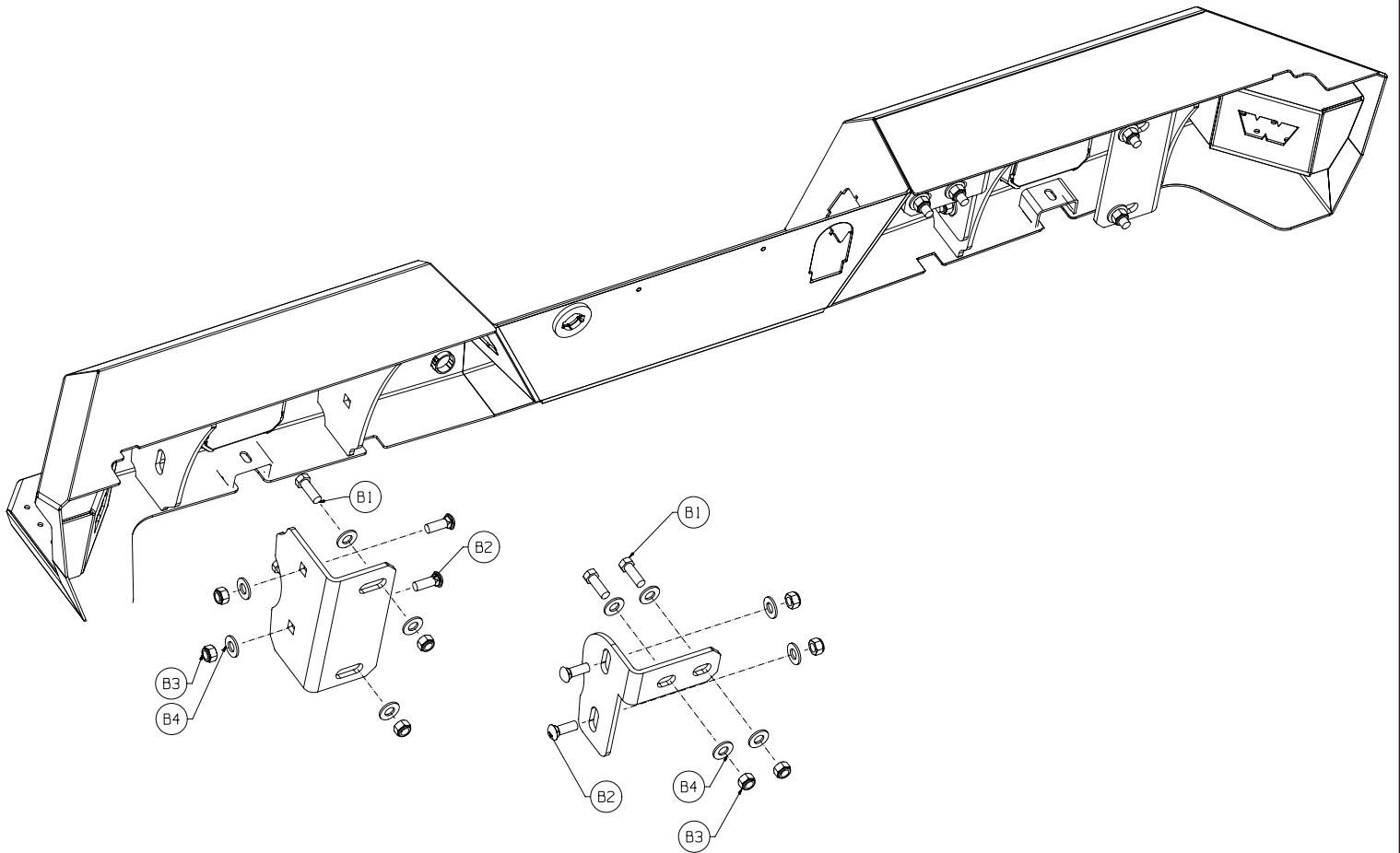

INSTALLATION INSTRUCTIONS



Figure 1

1. Disconnect trailer wire harness located above spare tire.



Figure 2

2. From underneath the vehicle frame on driver side, disconnect ground wire. Unclip zip tie from top of frame to completely free ground wire harness.



Figure 3

INSTALLATION INSTRUCTIONS

3. Remove the three bumper nuts, from each side of the vehicle frame. Save the hardware as you will reuse it later.

⚠ CAUTION

- **Always** use assistance when moving or lifting heavy parts.

4. Carefully remove the rear bumper and lay it face down on a semi-soft surface.

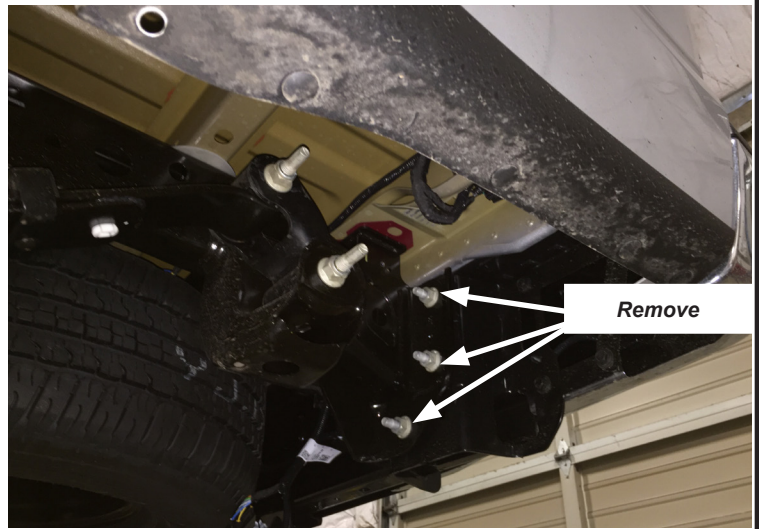

Figure 4

5. Remove the four back up sensors from the plastic housings.



Figure 5



Figure 6

6. Disconnect license plate lights.

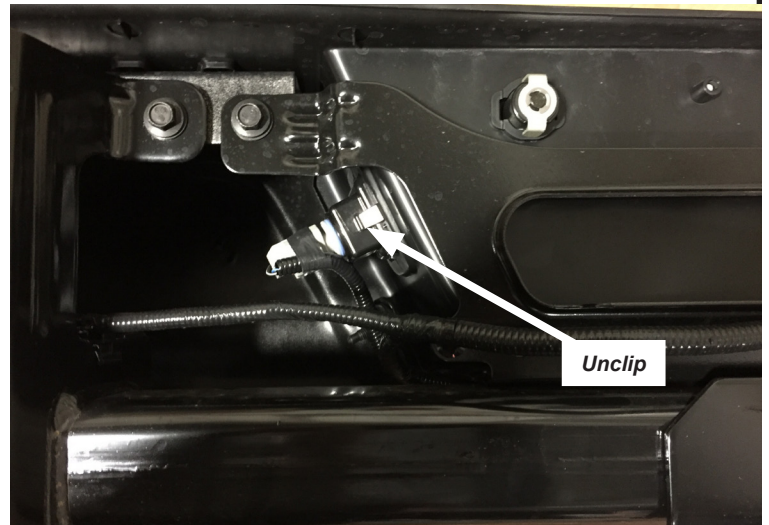

Figure 7

7. Remove trailer hitch wire harness.

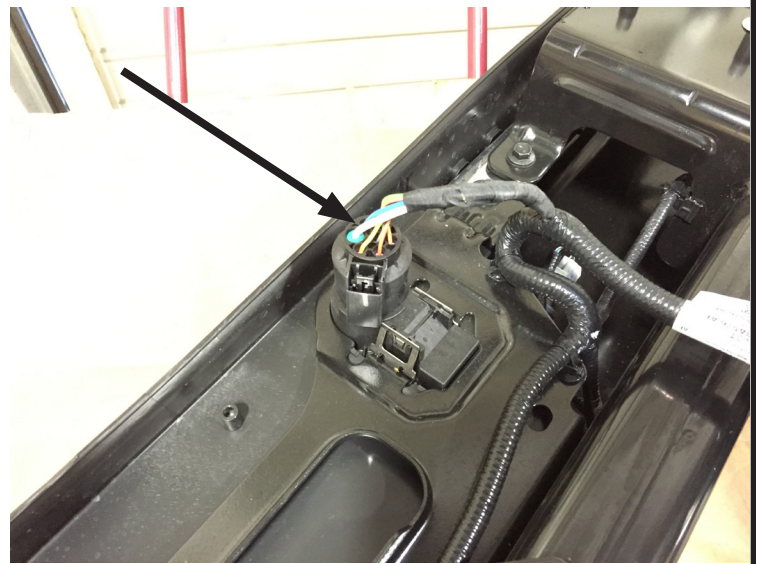

Figure 8

CAUTION

- Always use assistance when moving or lifting heavy parts.

8. Remove the four bolts from each side of the bumper.

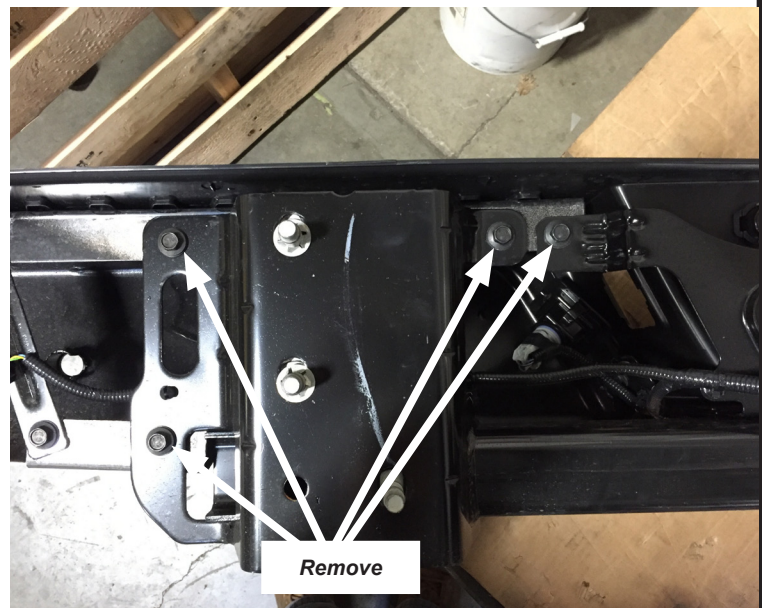

Figure 9

9. Remove plastic from bumper.



Figure 10

10. Remove bolt from each side of bumper to release hitch assembly.



Figure 11

11. Reinstall welded hitch assembly using the hardware removed in step 3.

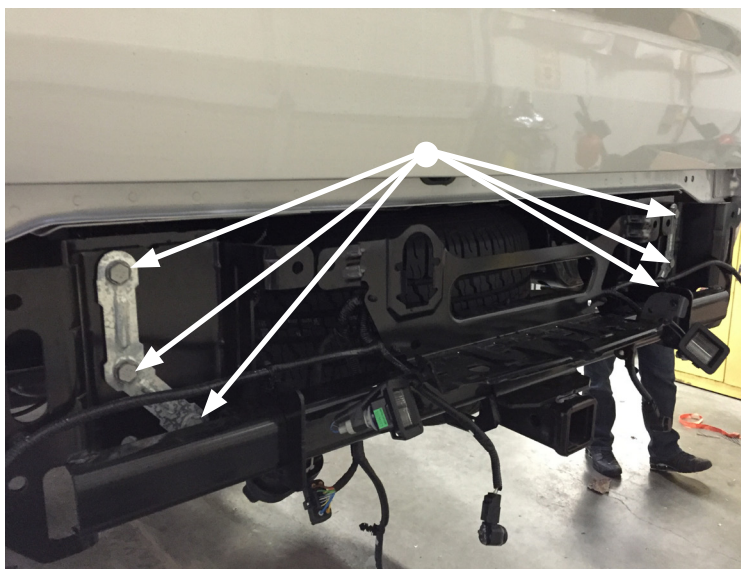

Figure 12

12. Attach the inner (A3 & A4) and outer (A2 & A5) bumper brackets to the factory mounting locations using hardware B1, B2, B3 and B4. Refer to exploded view on page 3.
13. Leave hardware loose until bumper is installed.

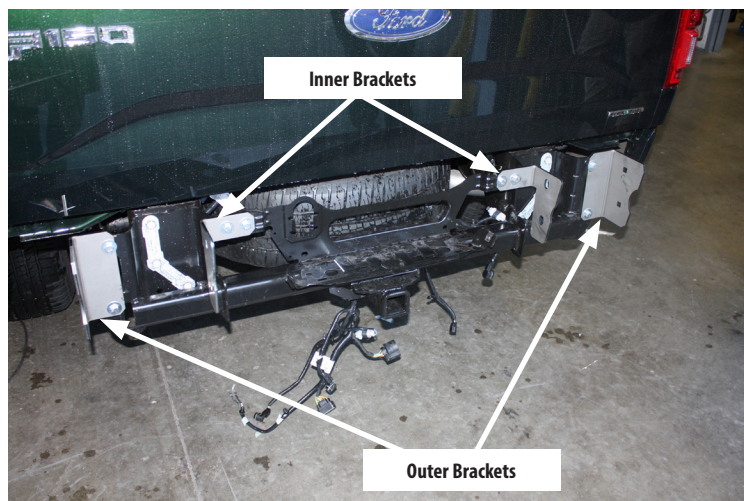

Figure 13

CAUTION

- Always use assistance when moving or lifting heavy parts.

15. With assistance:
 - a. Slide bumper onto brackets
 - b. Insert the rest of the hardware.
 - c. Center bumper.
 - d. **Tighten all hardware.**



Figure 14

16. Install the four back up sensor retainer housings into bumper.
17. Install license plate lamps, trailer hitch wire harness and spare tire rod locking cover.
18. Feed the wire harness along backside of the bumper and fasten up and out of the way with the zip ties provided.

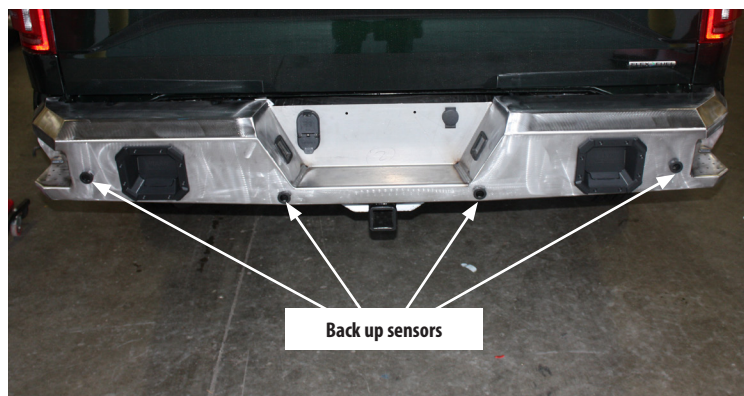

Figure 15

OPTIONAL Light Bezels Shown

19. Install light bezels after your electrical is complete using the stainless hardware provided in your kit.

MAINTENANCE / CARE

1. Inspect all parts on the winch, winch mount, and related hardware prior to each use. Replace all hardware that appears rusted or deformed.
2. Inspect all nuts and bolts on the winch, winch mount,, and related hardware prior to each use. Tighten all nuts that appear to be loose. Stripped, fractured, or bent bolts or nuts need to be replaced.
3. Check all cables prior to use. Replace cables that look worn or frayed.
4. Check all moving or rotating parts. Remove debris that may inhibit the part from moving freely.