



# INSTALLATION INSTRUCTIONS

## MID-FRAME BUMPER

Part Number: 95800

Application: 2015 Chevy 1500

### GENERAL SAFETY PRECAUTIONS

Your safety, and the safety of others, is very important. To help you make informed decisions about safety, we have provided installation and operating instructions and other information on labels and in this guide. This information alerts you to potential hazards that could hurt you or others. It is not possible to warn you about all potential hazards associated with this product, you must use your own good judgment.

**CARELESS INSTALLATION AND OPERATION CAN RESULT IN SERIOUS INJURY OR EQUIPMENT DAMAGE. READ AND UNDERSTAND ALL SAFETY PRECAUTIONS AND OPERATING INSTRUCTIONS BEFORE INSTALLING AND OPERATING THIS PRODUCT.**

This guide identifies potential hazards and has important safety messages that help you and others avoid personal injury or death. WARNING and CAUTION are signal words that identify the level of hazard. These signal words mean:

▲WARNING signals a hazard that could cause serious injury or death, if you do not follow recommendations. ▲CAUTION signals a hazard that may cause minor to moderate injury, if you do not follow recommendations.

This guide uses NOTICE to call attention to important mechanical information, and Note: to emphasize general information worthy of special attention.

### ▲ WARNING

#### IMPACT AND MOVING PARTS ENTANGLEMENT HAZARD

Failure to observe these instructions could lead to severe injury or death

- **Always** take time to fully read the Instructions and/or Operations Guide, and/or Basic Guide to Winching Techniques, in order to understand your winch and its operations.
- **Always** use extreme caution when drilling on any vehicle. Make sure that all fuel lines, brake lines, electrical wires, and other objects are not punctured or damaged when/if drilling on the vehicle. Thoroughly inspect the area to be drilled (on both sides of material) prior to drilling, and relocate any objects that may be damaged. Failure to inspect the area to be drilled may result in vehicle damage, electrical shock, fire or personal injury.
- **Always** wear safety glasses when installing this kit. A drilling operation will cause flying metal chips. Flying chips can cause eye injury.
- **Always** use extreme caution when cutting and trimming during fitting.
- **Always** remove jewelry and wear eye protection.
- **Never** lean over battery while making connections.
- **Never** route electrical cables:
  - o Across any sharp edges.
  - o Through or near moving parts.
  - o Near parts that become hot.
- **Always** insulate and protect all exposed wiring and electrical terminals.
- **Always** install terminal boots as directed in installation instructions.
- **Always** use appropriate and adequate care in lifting components into place.
- **Always** insure components will remain secure during installation and operation.
- **Always** tighten all nuts and bolts securely, per the installation instructions.
- **Always** perform regular inspections and maintenance on the plow mechanism, fasteners, cable and related hardware.
- **Always** replace all worn or damaged parts before operating.
- **Never** operate this WARN product with damaged or missing parts.

Read installation and operating instructions thoroughly.

WARN INDUSTRIES, INC. 12900 S.E. Capps Road,  
Clackamas, OR USA 97015-8903, 1-503-722-1200, FAX: 1-503-722-3000  
Customer Service: 1-800-543-9276  
Dealer Locator Service: 1-800-910-1122  
International Fax: 1-503-722-3005

## ⚠ CAUTION

### MOVING PARTS ENTANGLEMENT HAZARD

Failure to observe these instructions could lead to minor or moderate injury

- **Always** take time to fully read and understand the installation and Operations Guide included with this product.
- **Never** operate this product if you are under 16 years of age.
- **Never** operate this product when under the influence of drugs, alcohol or medications.

Read installation and operating instructions thoroughly.

## NOTICE

### EQUIPMENT DAMAGE

- **Always** refer to the Installation and Specification Guide, supplied in the winch kit, for all wiring schematics and specific details on how to wire this WARN product to your vehicle.

Read installation and operating instructions thoroughly.

## BEFORE YOU BEGIN

## NOTICE



This product may interfere with driver assist systems such as adaptive cruise control and parking assist systems that have sensors or cameras installed in the bumpers or front grill area. If your vehicle is equipped with any of these systems or features, consult your vehicle owner's manual before installing this product. These systems may need to be disabled as a result of installing this product.

## TABLE OF CONTENTS

Tools Required.....	page 2
Torque Specifications.....	page 2
Parts List.....	page 3
Installation .....	page 4-9
Maintenance/Care.....	page 10

## TOOLS REQUIRED

- Standard wrenches
- Standard sockets

## TORQUE SPECIFICATIONS

Please use the recommended torque specifications when assembling this product unless otherwise specified in the instructions.

FASTENER SIZE			FASTENER TORQUE		
	lb-ft	(N.m)		lb-ft	(N.m)
1/4"	8	(11)	M4	(2)	3
5/16"	17	(23)	M5	(4.5)	6
3/8"	30	(40)	M6	(7.5)	10
7/16"	48	(66)	M8	(18)	25
1/2"	74	(100)	M10	(37)	50
9/16"	106	(144)			
5/8"	148	(200)			
3/4"	269	(364)			

# PARTS LIST

ITEM	PART NO.	DESCRIPTION	QTY	ITEM	PART NO.	DESCRIPTION	QTY
A1	95985	WLDMNT MFB CHEVY 1500 MY15	1	B1	13483	1/2"-13 X 2 1/4, HEX CAPSCREW	14
A2	95980	RH LOWER FRAME EXTENSION WELDMENT	1	B2	9213	1/2" FLAT WASHER	42
A3	95989	LH LOWER FRAME EXTENSION WELDMENT	1	B3	2596	1/2, LOCK WASHER	14
A4	95438	WLDMNT LIGHT BRKT LH	1	B4	1390	7/16-14 X 2, HEX CAPSCREW	4
A5	95458	WLDMNT LIGHT BRKT RH	1	B5	2583	7/16-14, HEX NUT	4
A6	94888	RH LIGHT BEZEL	1	B6	1323	1/2-13, HEX NUT	14
A7	94889	LH LIGHT BEZEL	1	B7	2146	7/16, LOCK WASHER	4
A8	96118	LH UPPER FRAME EXT BRKT	1	B8	91541	10-24 X 1-SOCKET HEAD SCREW	20
A9	96123	RH UPPER FRAME EXT BRKT	1				
A10	96206	.125 SHIM	2				
A11	96207	.250 SHIM	2				

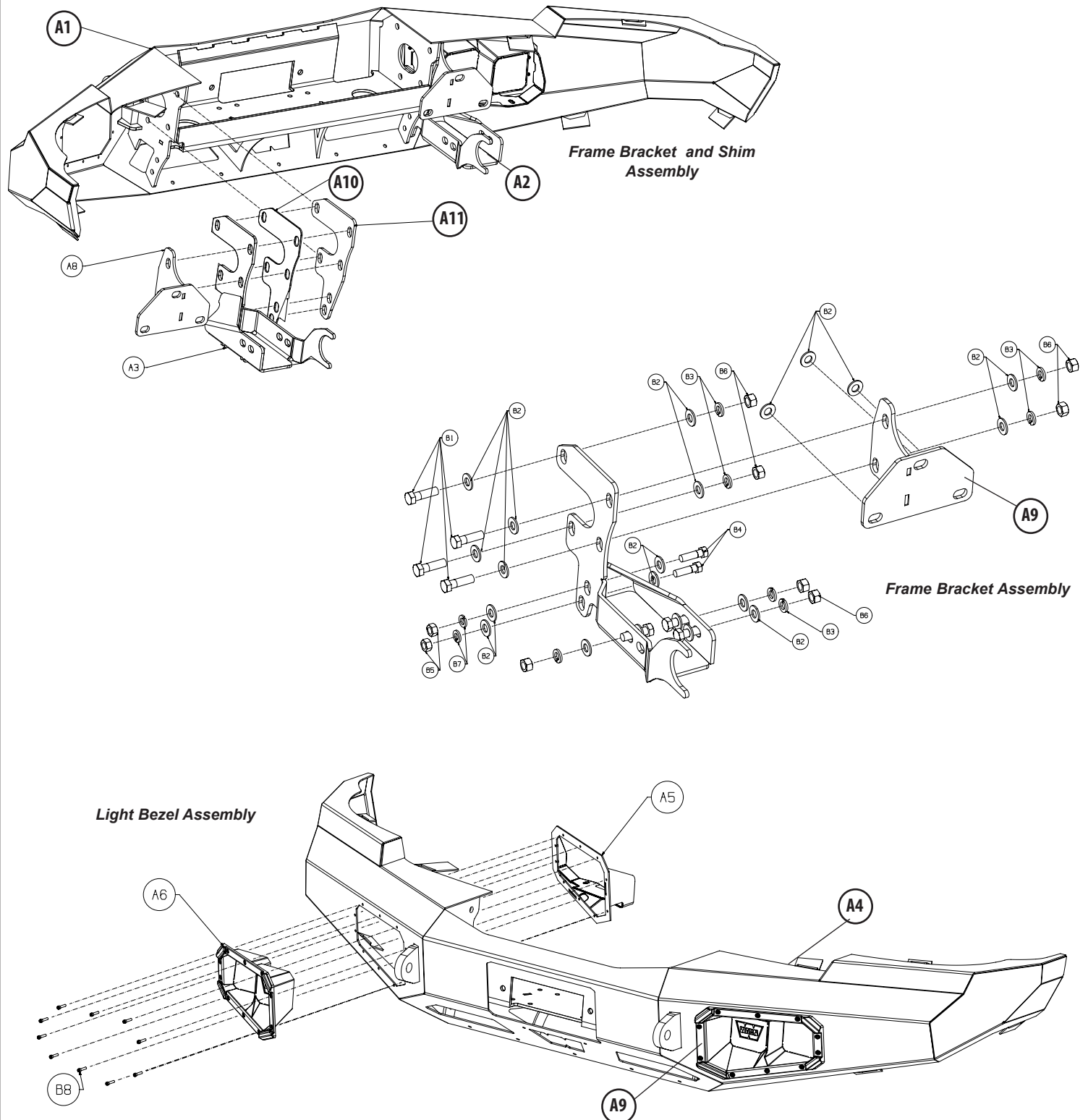

# INSTALLATION INSTRUCTIONS



Figure 1

1. Remove the plastic shroud covering the radiator by removing the 12 plastic push/pull pins.

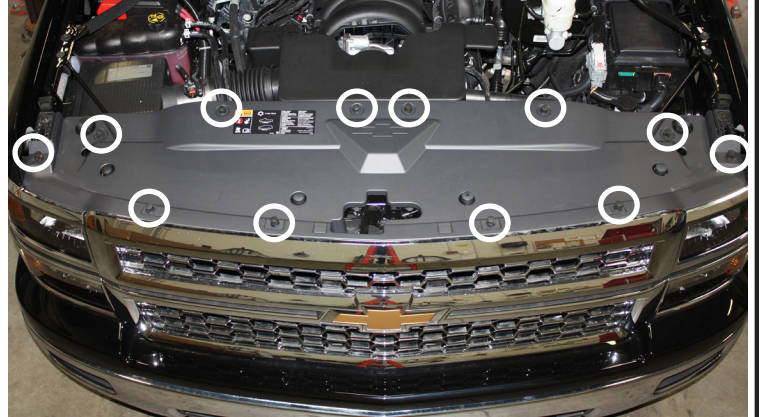

Figure 2

2. Remove the four screws that hold the top of the grill in position.



Figure 3

3. From underneath the vehicle, remove the two screws holding the lower part of the grill in position.

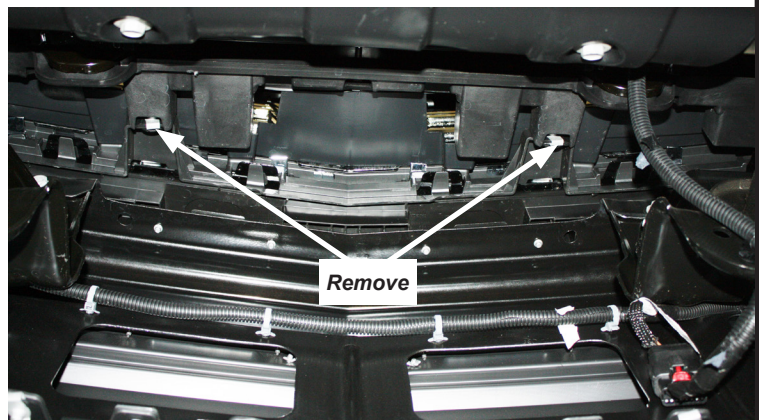

Figure 4



## INSTALLATION INSTRUCTIONS

4. There is an additional mounting screw toward the outside of the bumper, (located just above the front body mount, to the inside of the top portion of the bumper). Remove - both sides.

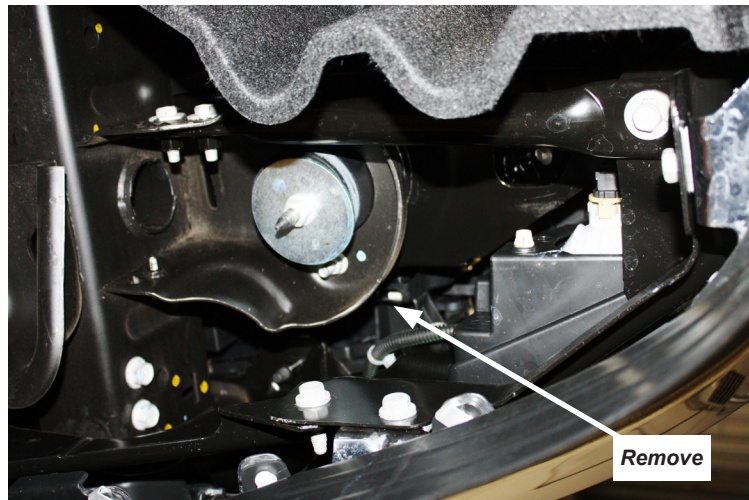

Figure 5

5. Unplug/detach the fog lamp harness located behind the center of the bumper.

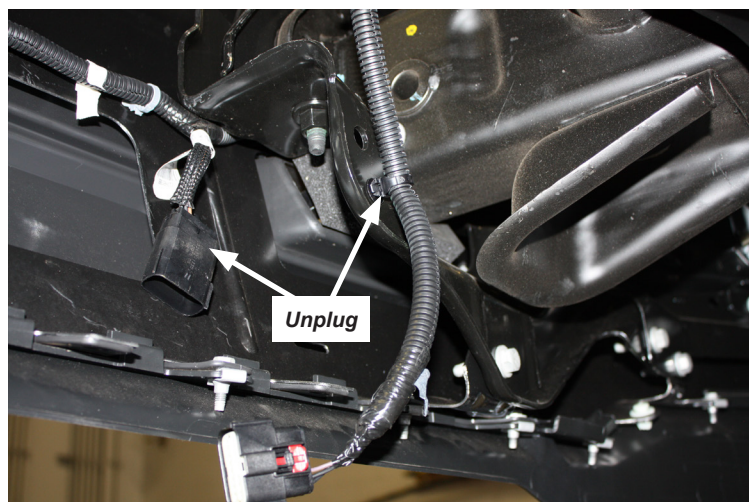

Figure 6

6. Remove the five screws holding fender well cover in place, both sides.

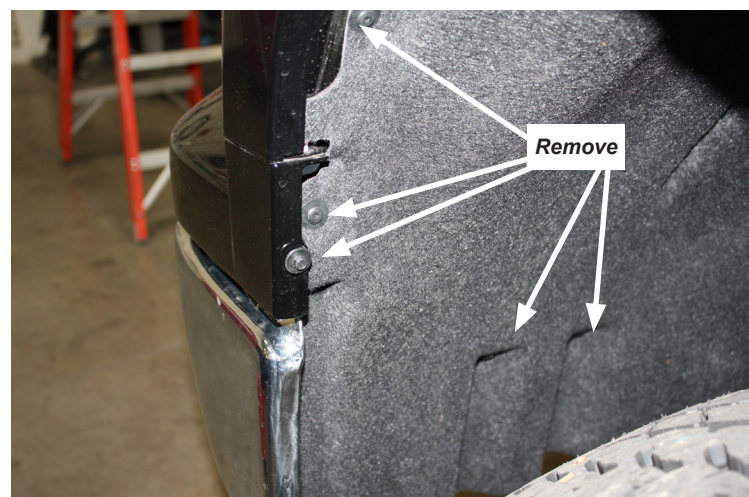

Figure 7

7. Remove the two screws holding plastic bumper cover in place (both sides). Remove completely.

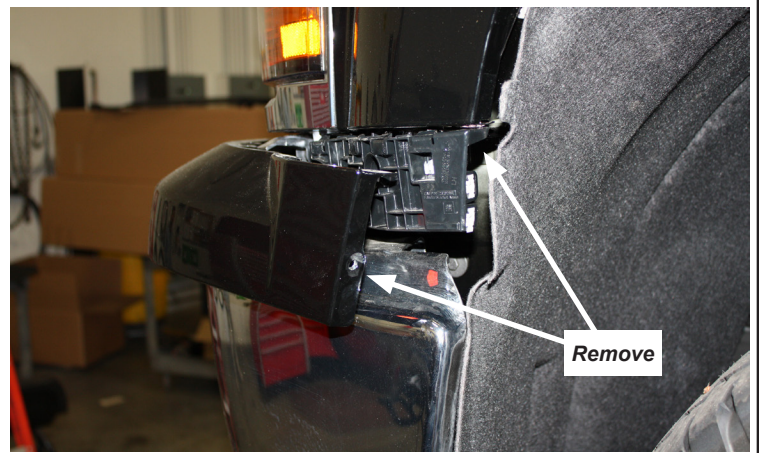

Figure 8

8. Remove the plastic brackets by unscrewing the three screws securing bracket in place (both sides).

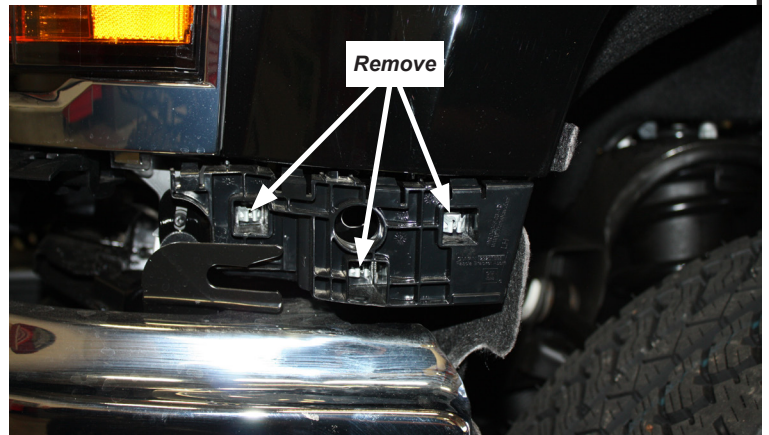

Figure 9

9. Gently start pulling the top of the grille away from the vehicle. You want to make sure the top of the grill releases from the detents and then gently start pulling at the ends where you removed the screws in the previous step, working your way around the bottom to the front of the grille to remove completely.

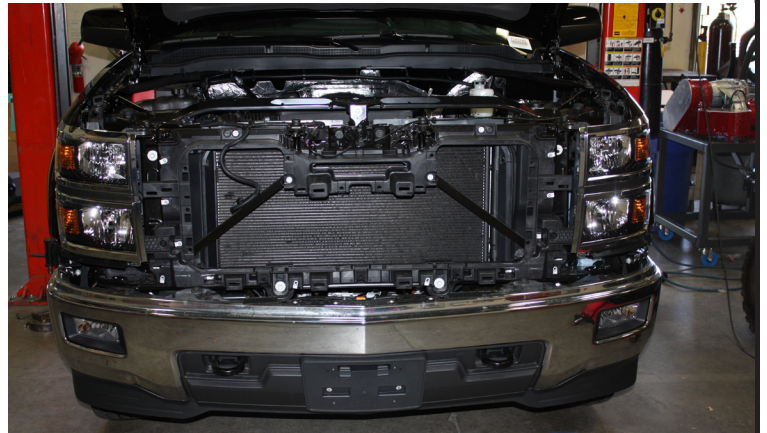

Figure 10

10. Depress tabs to separate plastic from grille.

**NOTE: Once you have removed the plastic on bottom side of grille, you can reinstall the grille.**

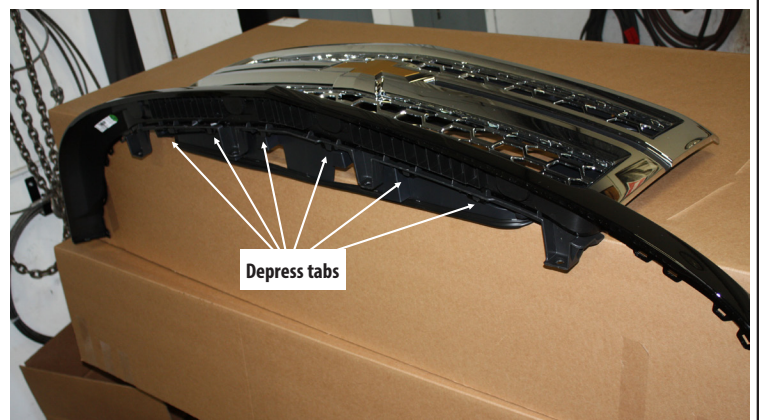

Figure 11



## INSTALLATION INSTRUCTIONS

11. Remove the bolts from the bumper end brace (both sides).

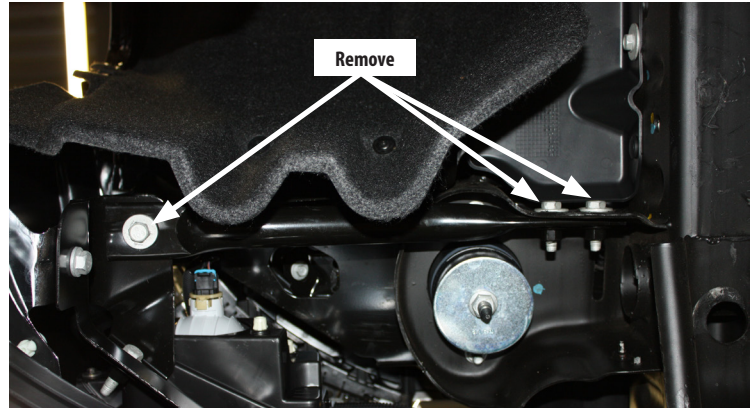

Figure 12

12. Remove the three bolts (from each side) that attach the bumper to the vehicle frame.

**NOTE:** *Save hardware, as it will be used later with extension brackets.*

### CAUTION

- Always use assistance when moving or lifting heavy parts.

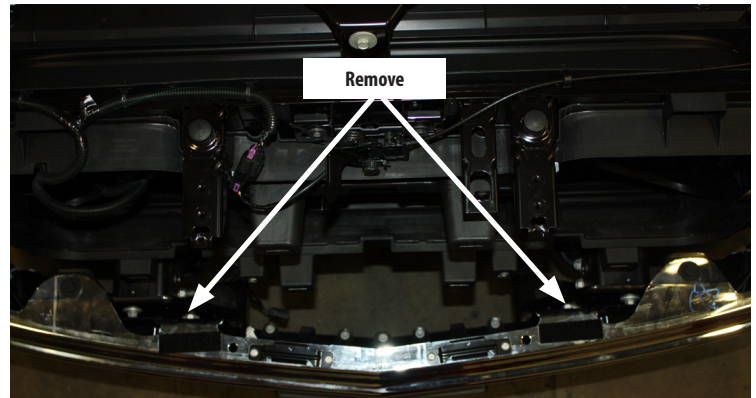

Figure 13

13. With assistance, carefully remove the bumper.

14. Remove the two bolts (each side) that secure the tow hooks to vehicle frame.

15. Remove tow hooks completely. You will not be reusing.

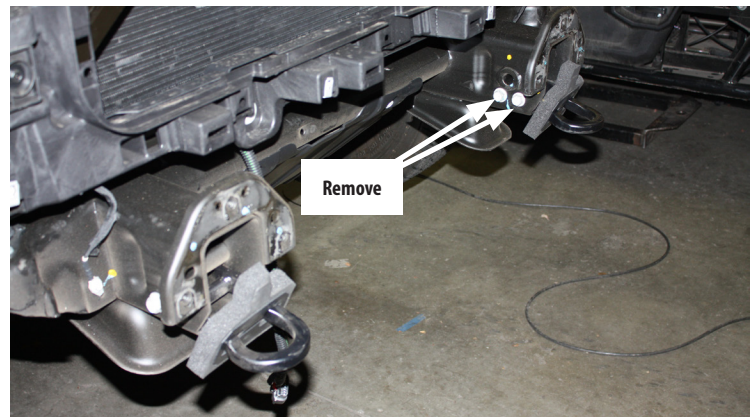

Figure 14

## INSTALLATION INSTRUCTIONS

16. From underneath the vehicle, near headlight - remove the two screws holding the plastic bracket.
17. Repeat for other side.

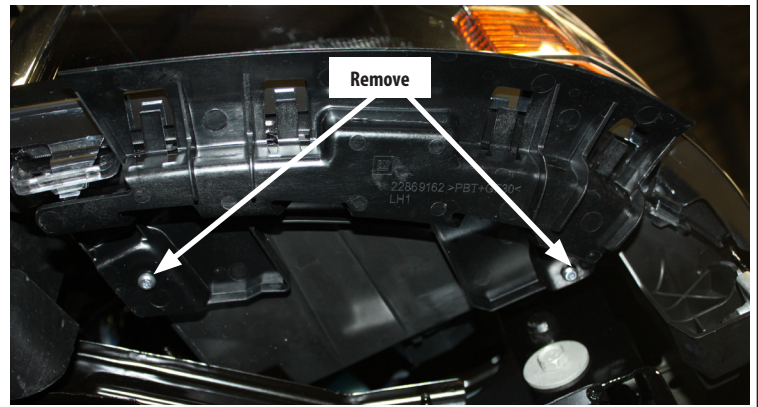

Figure 15

18. Install the lower frame extension weldments (A1 and A2), using two 1/2" bolts (B1), two washers (B2), a lock washer (B3) and a nut (B6), supplied in kit.
19. Repeat for other side.

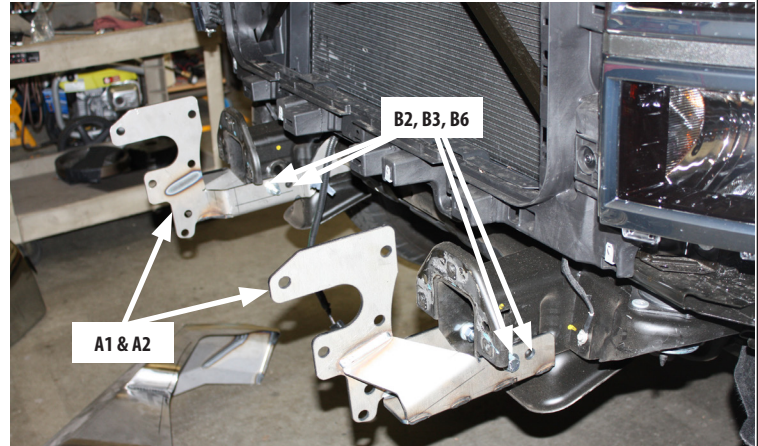

Figure 16

20. Using factory hardware (from step 12) and three washers found in this kit (B2), install upper frame extension brackets (A8 and A9) to front of frame rail flange. **Do not tighten at this time.**

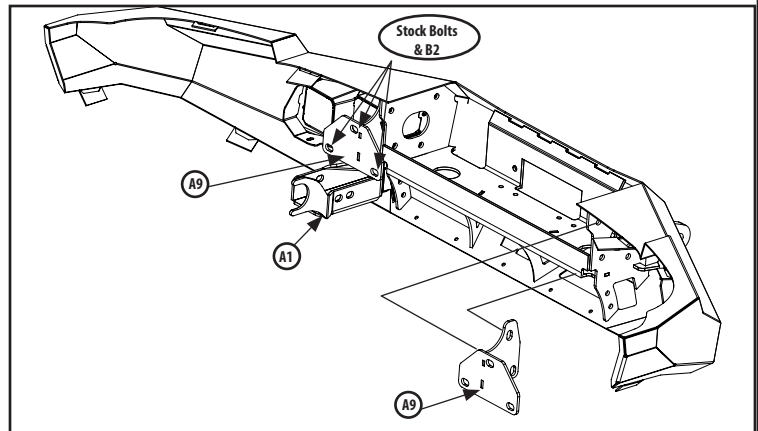

Figure 17

21. Slide bumper on to frame brackets and install the 1/2" bolts (B1) with washers (B2), lock washer (B3) and nut (B6) - along with two 7/16" bolts (B4), washers (B2), lock washers (B7) and nuts (B5) supplied in your hardware kit. Refer to exploded view on page 3.

**NOTE:** The bumper will require shims (A10 and A11) to take up the space between the bumper and the frame bracket. Use multiple sizes if necessary to center the bumper. You may want to use zip ties or black electrical tape to hold shims in place while installing bumper. Refer to exploded view on page 3.

22. Repeat for other side.

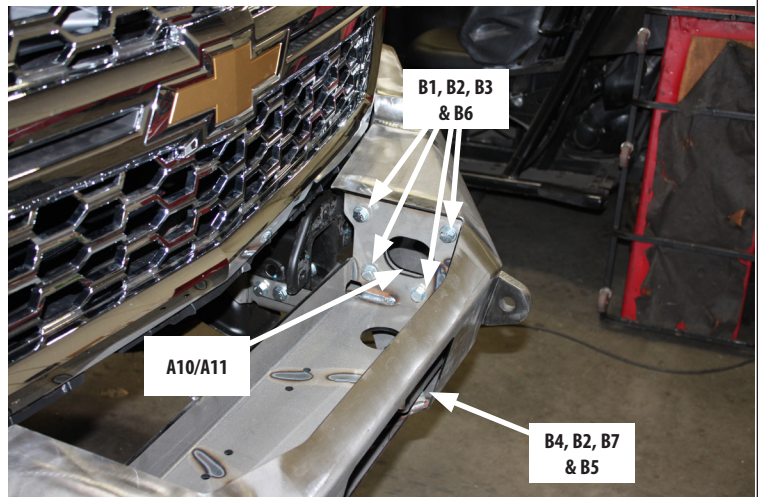

Figure 18



23. With assistance, adjust bumper and tighten all hardware at this time.

24. Repeat for other side.



Figure 19

25. While holding light bracket (A5) in place (from under and behind bumper), line up light bezel (A6) through front bumper light port to bracket. Secure pieces together with ten stainless steel socket head screws (B8). Review exploded view on page 3.

26. Repeat for other side.

**NOTE:** Light bezels are equipped with removable panels for lights. Lights show installed sold separately.

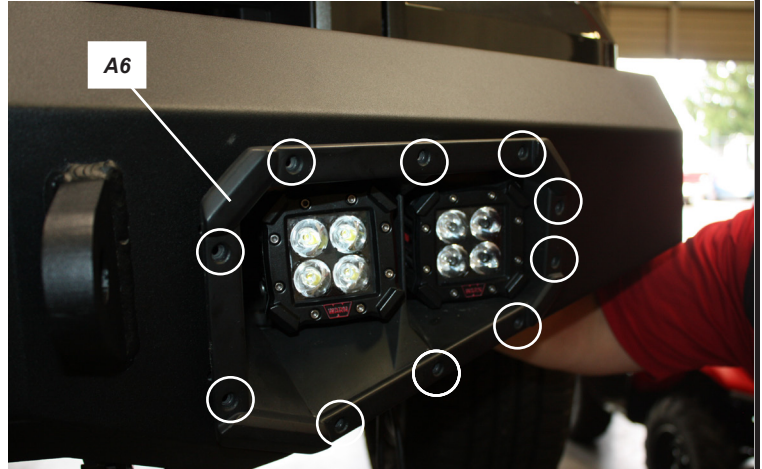

Figure 20

27. Mark inner fender skirt with tape to locate desired amount of excess to trim off. Carefully trim.

28. Your installation is now complete.



Figure 21

## MAINTENANCE / CARE

1. Inspect all parts on the winch, winch mount, and related hardware prior to each use. Replace all hardware that appears rusted or deformed.
2. Inspect all nuts and bolts on the winch, winch mount, and related hardware prior to each use. Tighten all nuts that appear to be loose. Stripped, fractured, or bent bolts or nuts need to be replaced.
3. Check all cables prior to use. Replace cables that look worn or frayed.
4. Check all moving or rotating parts. Remove debris that may inhibit the part from moving freely.